

Ultra compact MDS pack-fill automation

- Easy, one-person operation to prepare MDS prescriptions, scale up without more staff cost
- Differentiate your prescription service with easy-to-follow medication instructions and pictures
- Reduce prescription errors and improve patient loyalty
- Reduce inventory waste with expiring medication detection
- Increase storage space within your pharmacy
- Interfaces with a range of PMR systems for integrated workflow



Options at a glance



Machines for both blister or pouch packaging



Automated canister for automatic packing of halved and special shaped tablets



Scale output with additional cannisters, magazine and trays

Set up needs

Installation

- 1x power socket minimum (2 recommended as a back-up)
- 1x network point minimum (2 recommended as a back-up)

Software

- Patient Medication Record (PMR) integration.
- PMR interface varies according to the country of installation. PMR interface can be developed on demand. UK PMR interface examples:
EMIS-Proscript, PSL (Analyst), Cegedim, RxWeb, Apotec

Machines specifications

	JVM 208DOB Blister	JVM 208DO pouch
Floor space	Less than 1m ²	Less than 1m ²
Dimensions	993mm wide 560mm deep 2,040mm height	990mm wide 630mm deep 2,040mm height
Maximum operating speed	40 multi-dose blister cards/hour (28-day blister card)	50 multi-dose pouches/minute
Weight	375KG	300KG
Touch screens	26cm embedded touch screen (10.4")	
Electrical supply	220-240V	
Power consumption	230W (Max 660W)	230W (Max 660W)
Operating temperature	0-40°C	

Customisable configuration

	JVM 208DOB Blister	JVM 208DO Pouch
Blister or pouch options		
	<ul style="list-style-type: none"> Capacity to fill up to ten blister trays (7 x 4) continuously Up to 40 multi-dose blister trays filled per hour 	<ul style="list-style-type: none"> Up to 50 multi-dose pouches filled per minute
Auto-Canister		
	<p>Automatically dispense and package quarter and half dose tablets, and special shaped tablets. Some restrictions apply, contact your Omnicell sales representative for more information</p>	
Additional cannisters		
	<p>To extend your library of medications, beyond the 208 cannisters that come us standard with the machine. A minimum order of 10 additional cannisters applies</p>	
Additional trays		
	<p>Scale your operational capacity for increased output volumes</p>	<p>Not applicable for pouch machine</p>
Additional loading/ unloading magazines		
	<p>Scale your operational capacity for increased output volumes</p>	<p>Not applicable for pouch machine</p>

Customisable configuration continued

	JVM 208DOB Blister	JVM 208DO Pouch
STS Load Station + STS Assist Tray		
	Not applicable for blister machine	Provides sensor-controlled and light-guided manual loading of special shaped, half dose or infrequently used medications, to improve accuracy and reduce handling time
STS Assist Tray + STS Guide Light		
	Not applicable for blister machine	To provide light-guided manual loading of special shaped, half dose or infrequently used medications, to improve accuracy and reduce handling time
STS Assist Tray		
	Not applicable for blister machine	To assist with manual loading of special shaped, half dose or infrequently used medications, to reduce handling time
Packet Roller		
	Not applicable for blister machine	Conveniently feeds the pouch strip into the JVM 208 with automatic tensioning to speed up machine operation

JVM 208 Dimensions Drawings

JVM 208DOB (Blister)

Measurements in mm

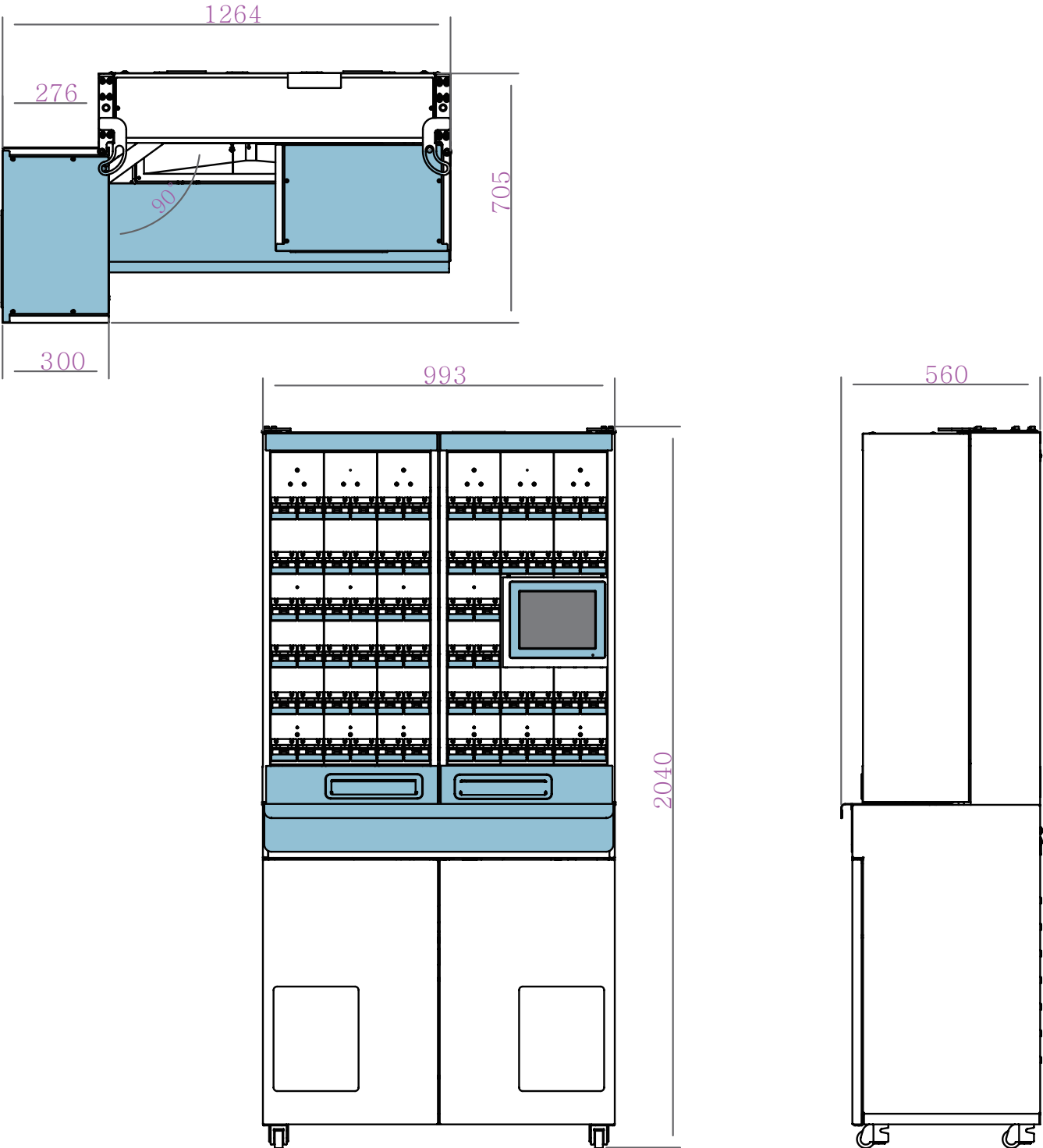

Model	Size (mm)	Weight (kg)	Canister (ea)
JV-208DOB	993 (w) x 560 (d) x 2,040 (h)	375	208

JVM 208 Dimensions Drawings

JVM 208DO (Pouch)

Measurements in mm

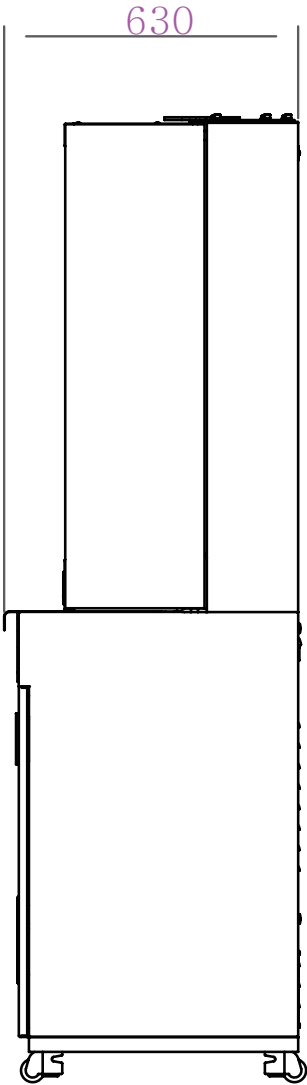
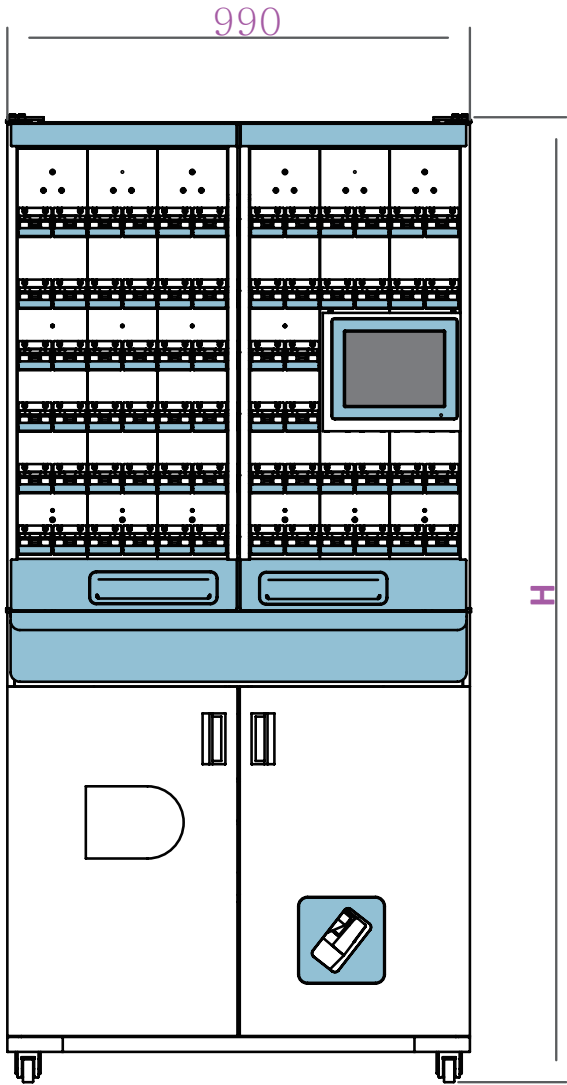
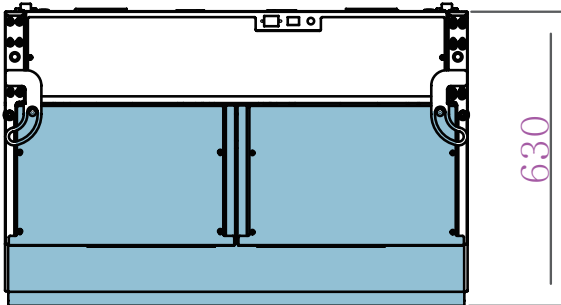

Model	Size (mm)	Weight (kg)	Canister (ea)
JV-208DO	990 (w) x 630 (d) x 2,040 (h)	300	208